

Aerial Map

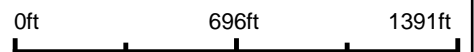

©2018 AgriData, Inc.

map center: 43° 10' 52.93, -95° 9' 23.43



Maps Provided By:

CUSTOMIZED ONLINE MAPPING
© AgriData, Inc. 2018 www.AgriDataInc.com

36-97N-37W
Clay County
Iowa



4/20/2018

Soils Map

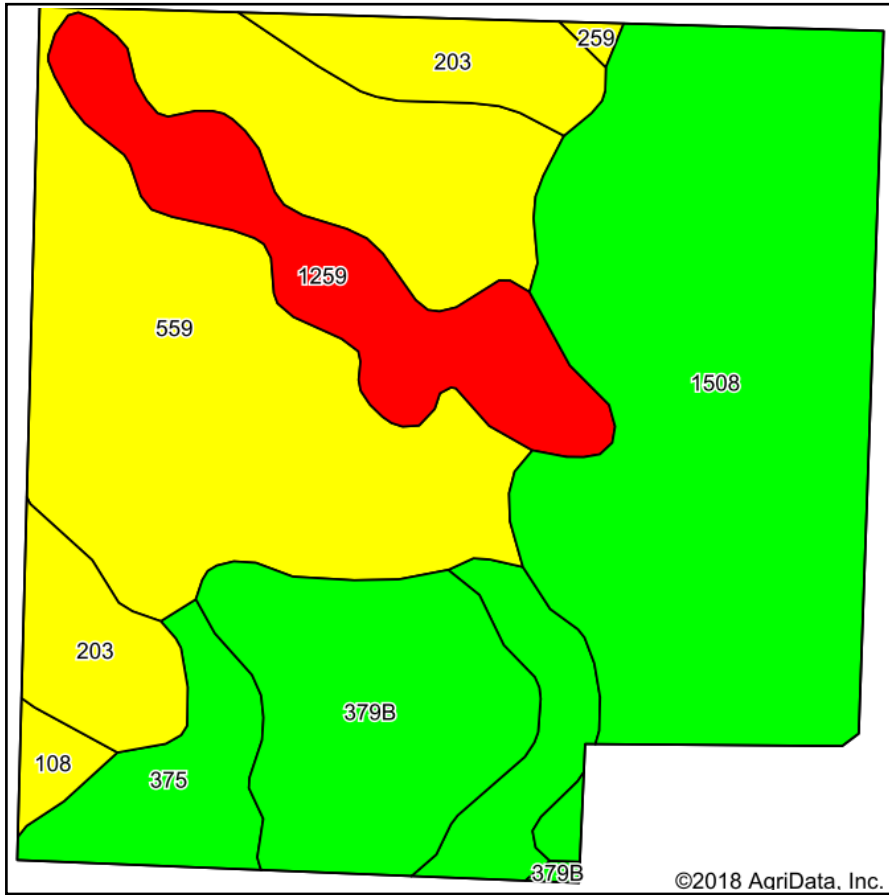

Soils data provided by USDA and NRCS.

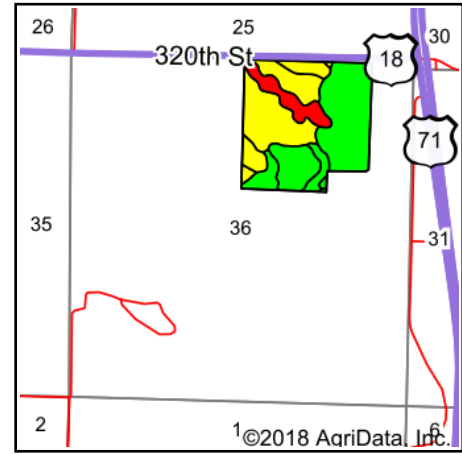

State: **Iowa**
 County: **Clay**
 Location: **36-97N-37W**
 Township: **Summit**
 Acres: **86.65**
 Date: **4/20/2018**

Maps Provided By:



Area Symbol: IA041, Soil Area Version: 27

Code	Soil Description	Acres	Percent of field	CSR2 Legend	Non-Irr Class *c	CSR2**	CSR	Spring wheat	Oats
1508	Belmann clay loam, 0 to 2 percent slopes	28.39	32.8%		Ilw	74	64		
559	Talcot clay loam, 32 to 40 inches to sand and gravel, 0 to 2 percent slopes	26.05	30.1%		Ilw	52	65		
379B	Ocheyedan clay loam, lacustrine substratum, 2 to 5 percent slopes	9.65	11.1%		Ile	87	62		
1259	Biscay clay loam, depressional, 0 to 1 percent slopes	7.89	9.1%		Illw	36	49	2	2
375	Fostoria clay loam, lacustrine substratum, 1 to 3 percent slopes	7.13	8.2%		Ile	83	70		
203	Cylinder loam, 0 to 2 percent slopes	6.50	7.5%		Ils	58	71		
108	Wadena loam, 0 to 2 percent slopes	0.86	1.0%		Ils	56			
259	Biscay clay loam, 0 to 2 percent slopes	0.18	0.2%		Ilw	52	70	2	2
Weighted Average						64.7	*-	0.2	0.2

**IA has updated the CSR values for each county to CSR2.

*- CSR weighted average cannot be calculated on the current soils data, use prior data version for csr values.

*c: Using Capabilities Class Dominant Condition Aggregation Method

Soils data provided by USDA and NRCS.